



ELECTRIC SIT-ON REACH TRUCK

Capacity: 1.4 - 2.0 ton

www.catlifttruck.com.sg

© 2014 by MCMC. All rights reserved. CAT, CATERPILLAR, their respective logos, "Caterpillar Yellow" and the POWER EDGE trade dress, as well as corporate and product identity used herein, are trademarks of Caterpillar and may not be used without permission. All registered trademarks are the property of their respective owners. Some products may be shown with optional equipment. Printed in Singapore.

PG49921

0014

CAT Lift
Trucks

ELECTRIC SIT-ON REACH TRUCK

Capacity: 1.4 - 2.0 ton



CAT Lift
Trucks

The Leader in Reach Truck Innovation

The NRF-CA Series

NRF-CA Series, one of the most reliable and versatile trucks in the industry that perform without compromise in standards. Regardless of using it to lift, transport or maneuver your goods within the warehouse environment, you can be ensured of its compact structure and powerful drive system that never fails to outperform your expectations.

SICOS-AC system

(Super Intelligent Control System for AC Control)



THE MULTIFUNCTIONAL CENTRALIZE CONTROL SYSTEM FOR AC CONTROL

NRF-CA employs sophisticated SICOS-AC system, featuring a new type of controller that is fully compatible with the AC system. It is now able to exhibit powerful and more advanced capabilities. By integrating travel, hydraulic and electrical power steering functions into one functional control system, the operator is now empowered to work more efficiently and comfortably.



AOS semi-auto stacking system (Optional)

Once you have keyed in your preferred rack height into the system memory, the AOS semi-auto stacking system raises the forks to that height at the touch of a button. This feature is a great advantage for loading / unloading goods from your most commonly used racks as well as high racks that are difficult to see.*

* Operator must visually confirm fork position before loading / unloading.



Shock absorption mast and soft landing mechanism

A shock absorption function for the mast relieves any shock from occurring while lifting. The speed at which the forks are lowered is reduced just before the forks reach the ground. Thus, it eliminates any shock to the load. This function prevents the loads from damage due to any direct impact or shock and it is a perfect solution to handle brittle loads.



* Picture above is for illustration purpose only. Please contact your local dealer for more information.

* Picture above is for illustration purpose only. Please contact your local dealer for more information.

Universal Steering with Digital Display

Experience the **universal 360 degree electric power steering (EPS)**. The 360 degree EPS provides a comprehensive driving experience for your operators to move around with the forklift smoothly without having to worry on the operators' troublesome drive preferences. Both wheel direction and forklift information are displayed onto the digital display for a **clear indication** of the truck's real time status.



Wheel indicator

The wheel indicator on the display instantly shows the real time direction of truck movement.

The easy-to-read display shows:

- ▶ Traveling speed
- ▶ Battery discharge status
- ▶ Current time
- ▶ Operating hours



Self-diagnosis function

With **SICOS-AC, NRF-CA** can easily **perform self-diagnosis** and **display real time error code** messages on the display panel to alert the operator.



Driving mode setting

Three modes of travel setting (**Economy / Neutral / Power**) are configured into NRF-CA to accommodate the operator's drive experience and also the site condition. With the **selectable maximum speed and acceleration**, it enhances the operator's confidence to operate the truck efficiently regardless of any warehouse setting.

Dynamic & Powerful Acceleration for Enhanced Work Efficiency

Move Swiftly like a Bee

Experience high efficient driving, lifting and turning with our unique **SICOS - AC System**, which provides an optimal control over the powerful travel and hydraulic motors performance. It is highly versatile to suit any operators' skill level as you can be ensured of its simplicity in the controls design that is specially designed for safer operation.



Excellent maneuverability for narrow spaces

Steer Endlessly like no limit

By completely redesigning the frame, we've reduced the minimum turning radius and right angle stacking aisle width. As a joint result with newly adopted 360° endless steering, we now lead the industry in space efficiency. At the same time, we've created a more spacious operating compartment to ensure maximum comfort for your operator.



Smooth, powerful lifting

Steady Lift with dependable stability

Both Mast and chassis rigidity was reinforced with a newly designed structure to ensure maximum stability for the operator to lift loads without any mast capacity lost, up to seven meters lift height.

*Tilt-able integral side shifter is included as part of a standard equipment.



Improved visibility

For safer, easier operation

We've improved the operator's forward field of view by mounting the free lift cylinder diagonally and off-center. What's more, we've carefully designed the overhead guard to avoid blocking the operator's over-head view. These innovations ensure significant improvement in work efficiency.



For easy management of multiple functions

Comfortable operation for enhanced ease-of-use

Ergonomically Designed Compartment

NRF-CA features several ergonomic innovations. The tilt-mounted fingertip levers and large armrests greatly reduce arm fatigue. The operator can finely adjust the both of steering panel position and seat position. We've included these advanced features as standard to ensure maximum comfort.



Fingertip control levers

Directional switch

Emergency stop switch

Easy to operate display panel

Adjustable steering column & 360 degree steering

Spacious operating compartment with padded, floor mat



Adjustable seat with Ergonomic contour

Active safety and easy maintenance

- ✓ *Enhanced features for operator safety.*
- ✓ *User friendly and easy to reach design for components.*

Travel-speed-sensitive lift speed control

This advanced safety innovation automatically slows lift speed and rotation when travel exceeds a set speed to prevent accidents from occurring.

Neutral safety feature

Neutral Safety Feature prevents the truck from sudden movement if the keyswitch is turned on while the accelerator is depressed or during operation of the hydraulic lever.

This is a critical safety feature to prevent accidents caused by equipment mishandling and would activate buzzer with warning display.

Battery forward pull-out system



Thanks to our convenient mast reach-out feature, the battery can be pulled out towards the front.

This greatly simplifies battery refilling and monitoring of battery electrolyte levels. It also eliminates the need for a battery table.

* To accommodate customers who frequently change batteries, the side-retract type is also available.

Cold storage applications

These water-resistant, moisture-resistant and rust-resistant trucks are designed to operate at the low temperatures typically found in industrial freezers.

CS class: -20°C continuous exposure**

23°C intermittent exposure***

FCS class: 23°C continuous exposure**

55°C intermittent exposure**

FCS class: 55°C continuous exposure** with option

*** 30-minute maximum operation time

** 60-minute maximum operation time

Automatic power-off

To reduce power consumption, the power is automatically shut off when the truck is left idle for 15 minutes or more.

Operation interlock system (OIS)

If the operator is not seated for more than two seconds, both travelling and hydraulic operations will be automatically deactivated.

Swivel type drive unit cover



The drive unit cover under the operator's seat can be fully opened, to provide more convenient access and easier maintenance.



Cat Lift Trucks is committed to providing industry-leading customer service, delivered by experienced and reliable material handling dealers. Cat Lift Trucks puts its customer's needs first, with one of the most comprehensive customer support programs in the business.

Dealers You can Depend On

Cat® lift trucks dealers are unsurpassed, delivering superior customer service that sets us apart from the competition before, during and after the sale.

Our dealers make available leading support programs with every new Cat lift truck you purchase, including:

- Genuine Cat lift truck OEM parts
- Planned Maintenance
- Rental fleet availability
- Convenient dealer branch locations

Planned Maintenance

Proper maintenance of your truck helps assure top performance over the long haul and helps extend truck longevity. That's why every Cat lift truck is backed by experienced and reliable dealers who make sure your truck is properly maintained.

With Cat lift truck planned maintenance, you won't have to worry about scheduling maintenance or unexpected downtime. Regular planned maintenance calls are scheduled in advance to avoid interference with your operating schedules. Experienced Cat lift trucks service technicians will regularly perform all periodic maintenance including fluid and lubricant check for a predetermined rate. We'll even identify and fix potential problems before they become major difficulties.

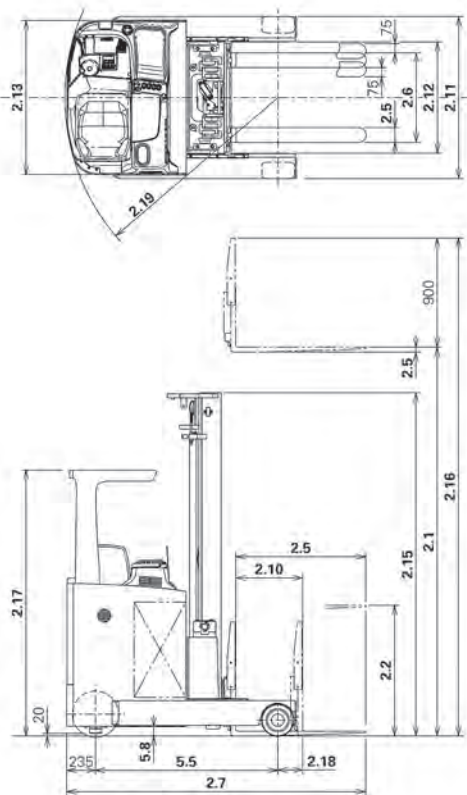

SPECIFICATIONS

Standard Specifications

Item	Summary	Unit	Electric Sit-On Reach Truck		
			NR70CA	NR75CA	NR70CA
1.2	Model		NR70CA	NR75CA	NR70CA
1.3	Fork/Load capacity	with integral loadshifter	1500 / 1500	1500 / 1500	1500 / 1500
1.4	Load center	C	400	400	400
1.5	Mast type		AC	AC	AC
1.6	Operator type	Stand-On / Seated	Seated	Seated	Seated
2.1	Lift height	H _{max}	3000	3000	3000
2.2	Free lift	H _{FL}	1765	1765	1775
2.3	Flt. range - Forks	Downward / Upward	2 / 5	2 / 5	2 / 5
2.4	Carrier bar		Hook type	Hook type	Hook type
2.5	Fork	Dimensions (L / W / T)	1075 / 102 / 25	1075 / 102 / 40	1075 / 102 / 40
2.6		Standard / Max / Min	230 / 230	230 / 230	230 / 230
2.7	SA length		220	220	220
2.8	Length	Frame	1730	1730	1780
2.9		to full rack	1710	1720	1720
2.10	Reach stroke	mm	555	555	555
2.11	Water	Full capacity	1270	1270	1240
2.12		Storage legs	802	802	815
2.13		Frame	1270	1270	1270
2.14		Leg	275	275	290
2.15		Max. extended	2665	2665	2675
2.16	Height	Max. extended	3000	3000	3000
2.17		Overhead guard	2140	2140	2190
2.18	Overhead	Reach out	180	180	180
2.19	Max. seating height	mm	1610	1705	1705
2.20	Min. 'R' (swing side) *	1050 x L1200 Pulley	1625	1875	1800
		1700 x L1200 Pulley	1825	1870	1800
2.21	Min. 'R' (reach side) **	1050 x L1200 Pulley	1620	2005	2010
		1700 x L1200 Pulley	1820	2045	2120
3.1	Travel speed	km/h / ft/min	12 / 32	12 / 32	12 / 32
3.2	Lifting speed	Lifted / Unladen	370 / 500	370 / 500	360 / 480
3.3	Lowering speed	Lifted / Unladen	500 / 400	500 / 400	500 / 400
3.4	Reach speed	Lifted / Unladen	150 / 200	150 / 200	150 / 200
3.5	Stability	AC	10 / 15	10 / 15	10 / 15
4.1	Service weight	w/o Battery	2385	2415	2700
4.2		Lifted / Unladen	2785 / 1730	2910 / 1805	2860 / 2080
4.3	Axle loading	rear / front	1150 / 1280	1170 / 1360	1360 / 2210
4.4	Unit - Battery	FLC	385 / 385	415 / 395	465 / 375
4.5	Reach out	FLC	1420 / 1440	1720 / 1440	1720 / 1750
5.1	Type - Number	Lead	2 / 1 *	2 / 1 *	2 / 1 *
5.2		Lead	a20x14 (20Ah/14h)	a20x14 (20Ah/14h)	a20x14 (20Ah/14h)
5.3	Type	Drive	a30x14 (30Ah/14h)	a30x14 (30Ah/14h)	a30x14 (30Ah/14h)
5.4		Capacity			
5.5	Wheelbase	mm	1350	1400	1500
5.6	Track	mm	1110	1160	1190
5.7		Drive			
5.8	Ground clearance	mm	70	70	80
5.9	Service brake	Motor / Reg. / Elec. / Press	Electric	Electric	Electric
6.0	Parking brake	Foot / Hand / Automatic	Automatic	Automatic	Automatic
6.1	Drive		Wet cell	Wet cell	Wet cell
6.2	Battery	Volts / Ampere hrs (20HR)	48 / 260	48 / 260	48 / 260
6.3		Max. fresh cells	2	2	2
6.4	Differential	Ratio / Gear	8.8	8.8	7.8
6.5		Control	Electric	Electric	Electric
6.6	Hydraulic system	Form / Rating	ISO / 2.0	ISO / 2.0	ISO / 2.0
6.7		Control	Electric	Electric	Electric
6.8	Power steering motor	Ratio / Ratio	5.0	5.0	5.0
6.9		Control	Electric	Electric	Electric
6.10	Charge	Type (DIN / JIS / Customary)	Charger	Charger	Charger
7.1	Operating pressure	bar / atmosphere	15.1	11.2	11.2

*) No clearance included